

**HARLEY-DAVIDSON® 95-12 TOURING MODEL
HI-OUTPUT SLIP-ONS EXHAUST
INSTALLATION INSTRUCTIONS
PART# 16455**



MORE POWER : LESS NOISE



Congratulations, you have purchased the finest exhaust system available for your motorcycle. Your Vance & Hines exhaust is designed and crafted for maximum performance, a great sound and unbeatable style. Please follow the instructions below, check exhaust system for missing or damaged parts and if you need any assistance please contact our technical support line (562) 921-7461.

Attention installer (if other than owner), please forward this instruction sheet to the owner of this product. These instructions contain valuable information to the end user.

**TOOLS
REQUIRED**

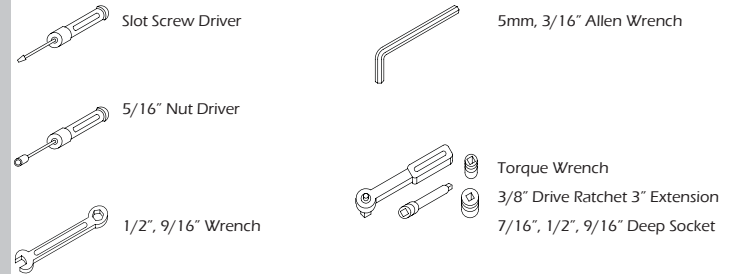

READ ALL INSTRUCTIONS BEFORE BEGINNING INSTALLATION

**STOCK EXHAUST
REMOVAL**

1. Remove both left and right saddlebags and set them aside.
2. Loosen the bolt from the pinch clamp on the front end of each muffler.
3. Remove the two 5/16" bolts that mount the muffler to the saddlebag supports. Repeat this step on the opposite muffler.
4. Remove the stock mufflers and set them aside. NOTE: It may be necessary to use a penetrating lubricant to loosen the muffler from the head pipe.
5. Leaving the grommets in place, remove the stock mounting brackets from the rubber grommets located on the saddlebag supports.
NOTE: Inspect the grommets, if they are damaged they will need to be replaced.

FIGURE 1



FIGURE 2



FIGURE 3

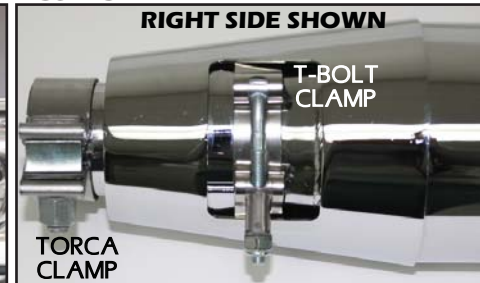



1. Install the muffler support brackets #757-P on the right side and #758-P on the left side (supplied), see (Figures 1 & 2).
2. Slide heat shield cone on muffler inlet with supplied T-bolt clamp installed with the T-bolt clamp facing down, leave loose, see (Figure 3).
3. Install the Torca band clamps (supplied) over the front of each muffler with the bolt facing down.
4. On 2009 and later models it may be necessary to loosen the stock heat shields before installing the mufflers.
5. Slide right side muffler on. NOTE: Dent will be on the inside, heat shield cone goes over the header heat shields.
6. Slide a Nut Plate (supplied) inside the bracket welded to the muffler and attach the muffler to the muffler support bracket #757-P using two 5/16 flange bolts (supplied). Finger tighten only.
7. Repeat installation procedure for opposite muffler.
8. Align muffler bodies then torque the Torca band clamps to 40-44 ft. lbs. Adjust the heat shield cone/clamp opening to face towards the rear tire. Tighten the heat shield cone T-bolt clamp also, Torque 90-125 in. lbs. Slide the muffler support bracket as far as possible rearward before tightening the two flange bolts. Torque the bolts to 18 ft. lbs.
9. After installation and before starting motorcycle, completely clean pipes and mufflers with cleaning solvent and a clean soft cloth that will not leave a residue. NOTE: Any residue, oil or fingerprints will stain the chrome when the metal heats up.
10. Be sure to check and tighten all hardware before starting your motorcycle.
11. Replace the saddle bags.

Note: After initial ride it is recommended to re-torque the baffle screws to 129 in. lbs. using a 3/16" allen wrench.

EXHAUST CARE - HELPFUL HINTS KEEP YOUR EXHAUST LOOKING NEW

1. When installing a new set of chrome pipes, make sure your hands are clean and free of oil. After installation, thoroughly clean pipes with a soft cloth and cleaning solvent that will leave no residue (chrome wax / polish, glass cleaner, alcohol, ammonia, etc...) before starting the motorcycle.

2. Avoid long periods of idling as this can cause discoloration.
3. Intake leaks can cause the engine to run lean and overheat, this could lead to discoloration.
4. Make sure there are no exhaust leaks at the junction of the exhaust pipes and cylinder head. We recommend replacing gaskets if they are worn.

VANCE & HINES OPTIONAL ACCESSORIES

FUELPAK



FUEL MANAGEMENT:

Maximize the efficiency of your improved air flow with properly managed fuel delivery by Fuelpak. Take the guess work out of fuel injection with Fuelpak Fuel Management. Contact your local dealer or call (562) 921-0071 to order. Visit fuelpakfi.com for more information.

Some Fuelpak systems are intended for use only on competition vehicles not used on public highways. For systems legal for use on public highways, please refer to ARB. E.O. No. D-632-1 or visit www.fuelpakfi.com.

PLEASE NOTE: Every effort is made for Vance & Hines Exhaust Systems to provide improved cornering clearance. However, due to design and space limitations on some motorcycle models, ground and cornering clearance may not be improved and in some cases may be reduced. Be sure to follow proper installation instructions.



PACKING LIST

16455 PARTS LIST		
PART NO.	Description	QTY.
D266RC	Megaphone Assy. Right	1
D267RC	Megaphone Assy. Left	1
D415HC	Heat Shield	2
A335HW	Torca Clamp	2
A519HW	T-Bolt Clamp	2
A195HW	Dog Bone Nut Plate	2
A240HW	HHCS, 5/16-18 x 5/8	4
A444HW	18-8 SS Capscrew 10-32, 3/8"	6
A157HW	Bolt, BHSCS 5/16"-18 x.5" Zinc Plt	4
757-P	Meg. Mounting Bracket, Rt	1
758-P	Meg. Mounting Bracket, Lt.	1
A117BEC	End Cap	2
A121R	Baffle Core Welded Assy.	2
A260FG	Baffle Sock	2

STOCK EXHAUST: 18.8 lbs
 16455: 25 lbs

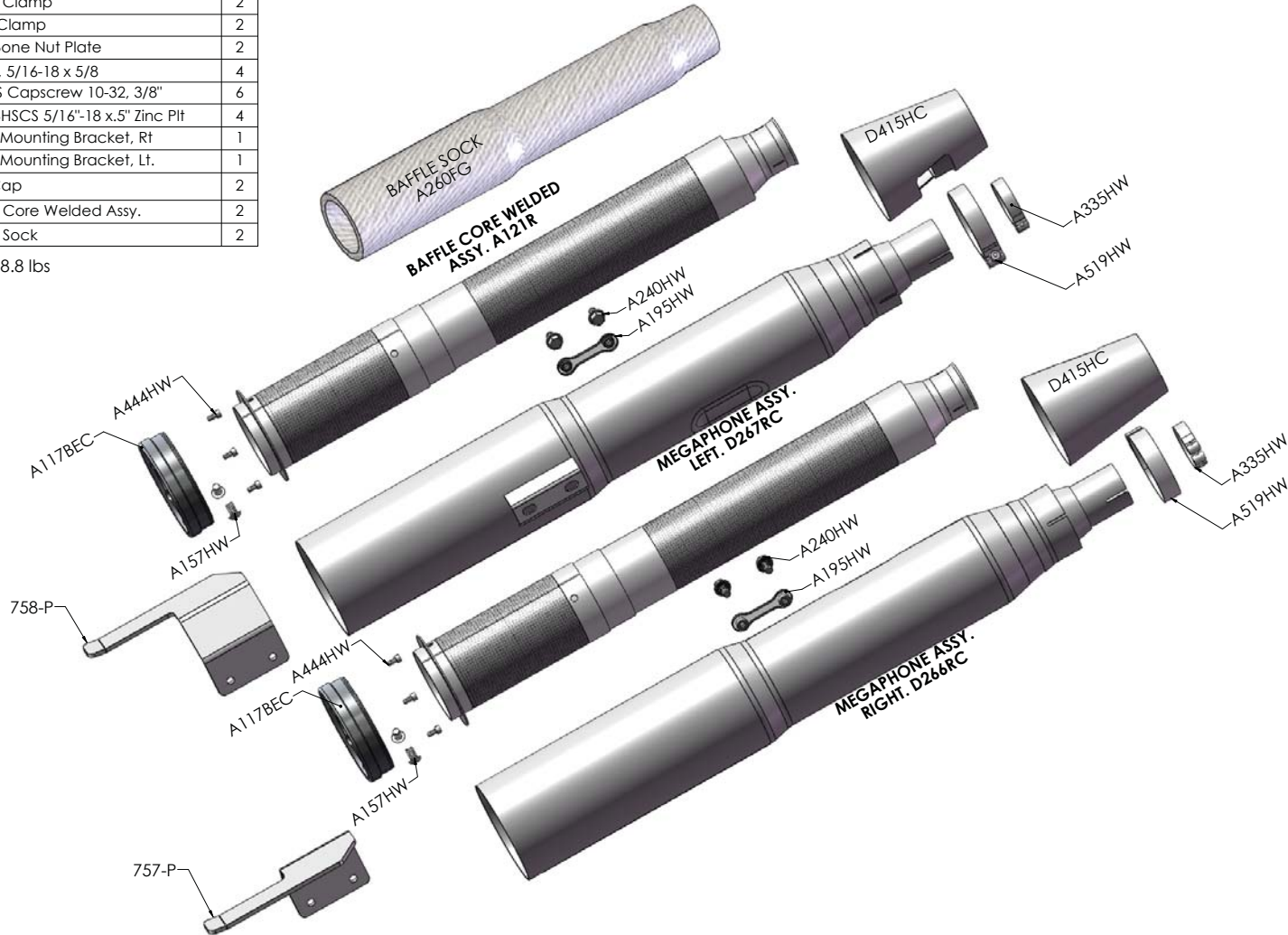

MORE POWER : LESS NOISE

ALL PARTS SHOWN ARE INCLUDED

WARRANTY

Vance & Hines products are warranted against defects in material and workmanship for a period of 90 days from the date of purchase from an authorized dealer. This warranty does not cover discoloration of chrome finishes. This warranty is limited to the repair or replacement of a product proven to be defective from normal use. Vance & Hines products are designed to fit and operate on OEM motor and chassis. This warranty does not cover any product subject to abuse, misuse, improper installation or modification.

GET THE MOST OUT OF YOUR RIDING EXPERIENCE...
 AN AFTERMARKET EXHAUST SYSTEM IS ONLY YOUR FIRST STEP, NOW YOU NEED FUEL MANAGEMENT.

NOW YOU NEED FUELPAK.

Your fuel injected Harley-Davidson® is equipped with an ECU (electronic control unit) that's programmed to deliver fuel to the motor based on an air/fuel ratio for a stock air filter and stock exhaust system. When you install a performance exhaust system, your airflow changes, so you need a fuel management system that adjusts your air/fuel ratio to match the changes. That fuel management system is Fuelpak. Fuelpak adds and takes away fuel, allowing for a more precise range of refinement in your air/fuel ratio. Get the perfect fuel management combination with your Vance & Hines exhaust system, get Fuelpak. For more information visit the tuning center at fuelpakfi.com



NOTICE: Fuelpak is intended for racing or off-highway use only, and is not legal for sale or use in California on pollution-controlled vehicles.

MORE POWER : LESS NOISE