



Softail Big Radius Exhaust System Part #26003

Congratulations, you have purchased the finest exhaust system available for your motorcycle. Your VANCE & HINES exhaust system is designed and crafted for maximum performance, a perfect fit, a great sound and unbeatable style! Please follow the installation instructions below and if you have any questions, feel free to call our technical help line (562) 926-5291.

Attention Installer: (if other than owner): Please forward this instruction sheet to the purchaser of this product. These instructions contain valuable information necessary to the end user.



STOCK EXHAUST SYSTEM REMOVAL

1. On FLSTN, FLSTF, FLSTH and FLSTC loosen the right hand floor board mounting bolts to gain clearance for exhaust removal and installation.
2. Loosen the heat shield clamps on both front and rear exhaust pipes.
3. Loosen the crossover pipe clamp, located between the front and rear head pipe. (Not necessary on 2000-up models).
4. Remove the two mounting nuts from each head pipe, located at the cylinder head.
5. Remove the bolts attaching the mufflers to the frame.
6. Remove the entire exhaust system and set it aside.

7. On pre 2000 models remove the lower mounting bar.
8. FLSTN, FLSTF and FXSTD models have an upper mounting bar that must be removed in addition to the lower bar. On pre 2000 models go to step #9, on 2000-up models go to step #10.
9. Remove the right passenger foot peg bolt. Position the motorcycle on the side stand with a floor jack under the swing arm pivot bolt on the right hand side. Raise the jack just enough to take the weight off the pivot bolt, remove the bolt and stock mounting bar. Reinstall the pivot bolt and torque to 120 -150 ft. lbs. Reinstall the passenger foot peg using the 1/2" x 3" Allen bolt and 1-5/8" length spacer (supplied).
10. Using a #50 Torx driver, remove the three mounting bolts, and set the mounting bar aside. (Two of the bolts are visible, the third is accessed by removing the right hand passenger foot peg.) Replace the foot peg using the 3/8" x 2 1/2" Allen bolt and 3/4" length spacer (supplied).
11. The bolts and spacers used in the above steps may also be used on all Softail models to space the right rear foot peg away from the exhaust.
12. Carefully remove the flanges and circlips from the stock exhaust system using snapping pliers (save for re-use). **NOTE: If circlips look bent or twisted replace them with new circlips.**

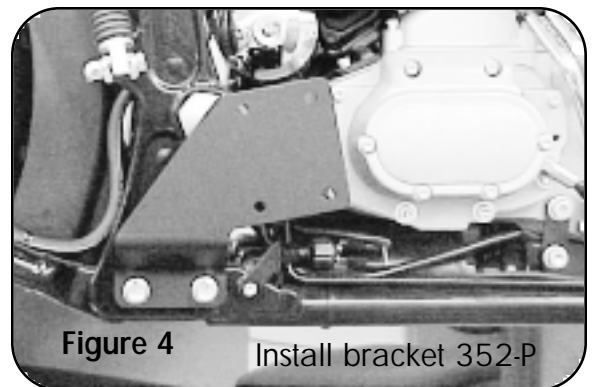
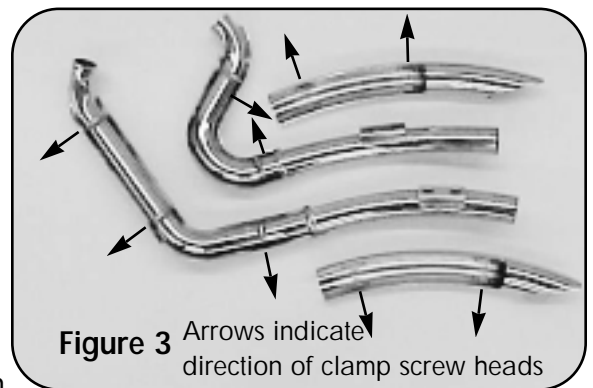
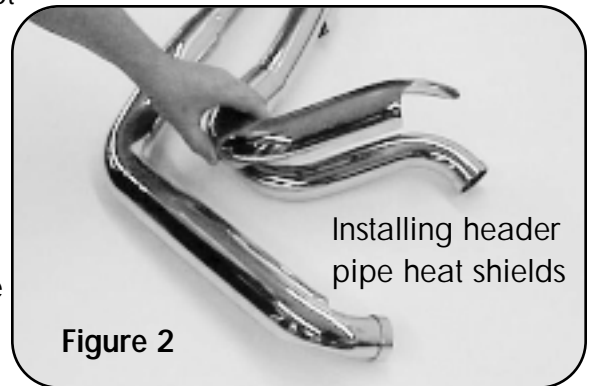
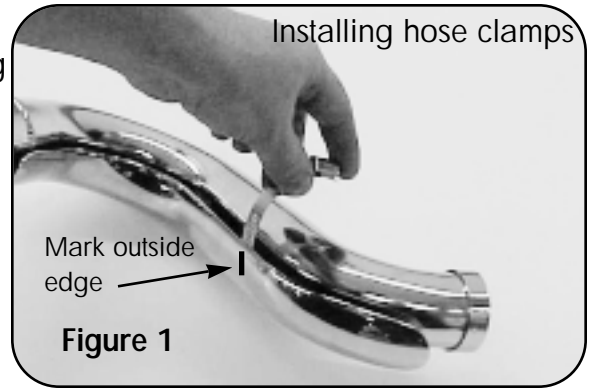

VANCE & HINES EXHAUST SYSTEM INSTALLATION

1. Check condition of stock exhaust gaskets. Replace if worn. Vance & Hines recommends you replace your gaskets with Screamin' Eagle gaskets, part number 17048-98.
2. Remove head pipes and heatshields from protective packaging. Place each heatshield on a non-abrasive surface such as a blanket or carpet. Using a felt tip pen, mark outside edge of each heat shield to show location of hose clamp mounting clips (Figure 1).
3. Lay head pipe heat shields (part # D305HC and D306HC) onto headers (Figure 2) and loosely install the #20 hose clamps into mounting clips. (**NOTE:** Muffler heat shields will be installed after pipes are on the motorcycle.) Take note of screw head direction (Figure 3). screw heads should be accessible when system is installed on motorcycle for adjustment purposes. **NOTE:** Do not tighten at this time.
4. Install circlips and flanges from stock system onto both new head pipes.

5. Install bracket (part # 352-P) to the two lower holes in frame below right passenger footpeg, using two 3/8"x3/4" flange bolts (supplied)(Figure 4).
6. Using stock flange nuts, carefully install head pipes onto motorcycle. **NOTE:** Do not tighten at this time.
7. Use the nutplates and 5/16"x5/8" flange bolts (supplied) to attach the pipes to the bracket (Figure 5). **NOTE:** Do not tighten at this time.
8. Align pipes on motorcycle so that the gap between the two muffler bodies is consistent from front to rear and tighten exhaust port flange nuts (Figure 6). Now tighten the 5/16"x5/8" flange bolts and finally the 3/8"x3/4" flange bolts attaching the bracket to the frame.
9. Using the #28 hose clamps install the muffler heat shields (part # D308HC and D309HC) starting with D308HC on the front head pipe. Take note of screw head direction (Figure 3)screw heads should be accessible when system is installed on motorcycle for adjustment purposes. **NOTE:** Do not tighten at this time.
10. Adjust the heat shields to get the best alignment at the seam where they touch and tighten all the hose clamps.
11. Check for adequate clearance between exhaust system and other motorcycle components.
12. Re-tighten floor board mounting bolts on models so equipped.
13. **Be sure to tighten all hardware before starting motorcycle.**

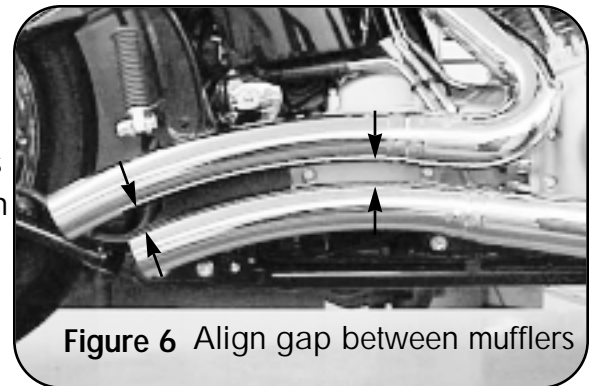
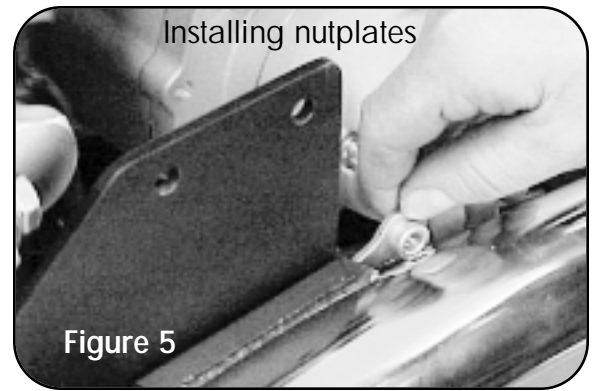

Option

On fuel injected models this system will work with Vance & Hines Fuelpak part number 61001. Order it today from your dealer or go to vanceandhines.com for more information.



RE-JETTING INSTRUCTIONS

Re-jetting the carburetors will result in realizing the "full" potential of this performance exhaust system. Vance & Hines offers jet kits for most applications. For fuel injected models, we recommend the use of Vance & Hines Fuelpak part number 61001.

PLEASE NOTE:

Every effort is made for Vance & Hines Exhaust Systems to provide improved cornering clearance. However, due to design and space limitations on some motorcycle models, ground and cornering clearance may not be improved and in some cases may be reduced. Be sure to follow proper installation instructions.

PACKING LIST (All parts actual size)

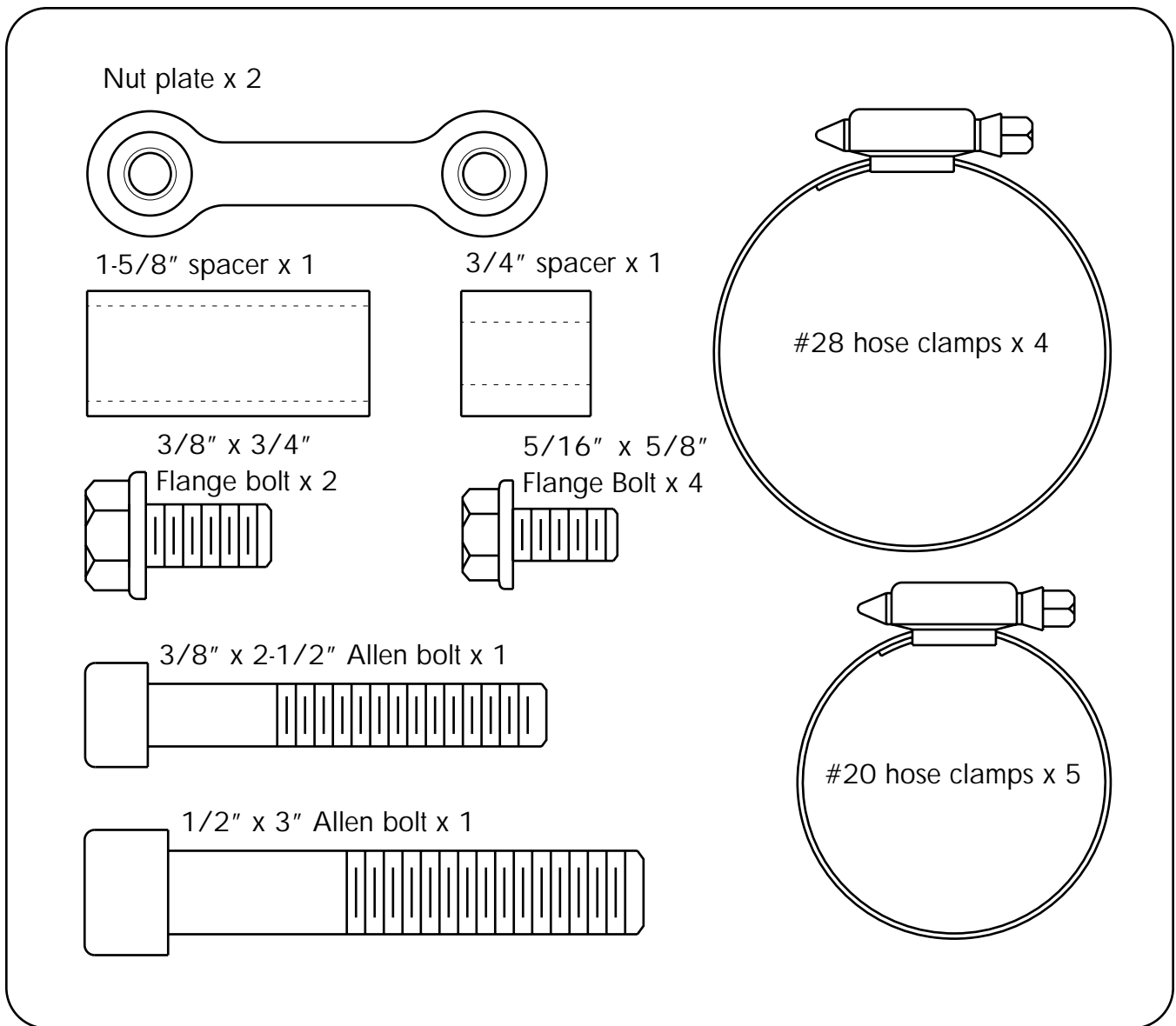

HELPFUL HINTS TO AVOID DISCOLORATION OF EXHAUST PIPES

1. Follow owner's manual instructions regarding use of the choke (starter enricher). If left on longer than recommended, discoloration may be accelerated.
2. Avoid long periods of idling.
3. Intake leaks can cause engine to run lean and overheat, thus turning the pipes blue.
4. Make sure there are no exhaust leaks at the junction of the exhaust pipe and cylinder head.
5. When installing a new set of chrome pipes, make sure your hands are clean and free of oil. After installation, thoroughly clean pipes with a cleaning solvent that will leave no residue (glass cleaner, alcohol, ammonia, etc.) before starting the motorcycle.

WARNING!

VANCE & HINES DOES NOT WARRANTY ANY CHROME PRODUCTS AGAINST DISCOLORATION.

For information on other Vance and Hines products visit our web site at www.vanceandhines.com