



Sportster 883/1200 Straightshot HS Exhaust system Part #17815

Congratulations, you have purchased the finest exhaust system available for your motorcycle. Your VANCE & HINES exhaust system is designed and crafted for maximum performance, a perfect fit, a great sound and unbeatable style! Please follow the installation instructions below and if you have any questions, feel free to call our technical help line (562) 926-5291.

Attention Installer: (if other than owner): Please forward this instruction sheet to the purchaser of this product. These instructions contain valuable information necessary to the end user.



STOCK EXHAUST SYSTEM REMOVAL

1. Loosen the heat shield clamps on both the front and rear exhaust pipes. This allows easier access to the head pipe mounting nuts.
2. Remove the two head pipe mounting nuts from each flange, located at the cylinder head.
3. Remove the two bolts from each muffler body which attach the muffler bodies to the mounting bar.
4. Remove the clamp bolt which mounts the rear head

Tools required for installation:

3/16" & 5/16" Allen wrenches
3/16" & 5/16" Allen & 1/2" sockets
3/8" Ratchet & Extensions
T30 Torx driver
1/2" Wrench
5/16" nutdriver/flat blade screwdriver
Ft/lb. & In/lb. Torque wrenches
Snapping pliers

pipe to the belt drive cover bracket and carefully remove both exhaust pipes from the motorcycle.

5. Remove the drive belt cover and take the bracket off the rear cover bolt, it will not be re-used.
6. Loosen the brake rod at the rear eyelet using a T30 Torx driver.
7. Remove the exhaust mounting bar, saving the three mount bolts and washers for re-use.
8. Using snapping pliers, carefully remove the flanges and circlips from the stock exhaust system. Save for re-use.

NOTE: If circlips look bent or twisted replace them with new circlips.

VANCE & HINES EXHAUST SYSTEM INSTALLATION

1. Check condition of stock exhaust gaskets. Replace if damaged or worn. Vance & Hines recommends you replace your gaskets with Screamin' Eagle gaskets part number 17048-98.
2. Install and tighten supplied mounting bracket (stamped 356-P) using stock bolts and washers (Figure 1). Torque to 30-33 Ft/Lbs. **NOTE:** Support the rear of the bracket during tightening to insure it is aligned with the bottom edge of the frame.
3. Re-install drive belt cover. Torque to 1 x 3/8" bolt 30-33 Ft/Lbs. 2 x 1/4" bolts 80-120 In/Lbs.
4. Re-install brake rod eyelet using blue thread locking compound (Loctite® 243). There is a 1/2" clearance hole in the bracket to allow access for tightening brake rod eyelet. Torque to 120/180 In/Lbs. (Figure 1).
5. Remove header pipes and heat shields from protective packaging. Place each heat shield on a non-abrasive surface such as a blanket or carpet. Using a felt tip pen, mark outside edge of each heat shield to show location of mounting clips where hose clamps will loop through (Figure 2).
6. Install circlips and flanges from the stock system onto both new head pipes.
7. Lay head pipes into heat shields and loosely install hose clamps by feeding tail end of clamp into heat shield clips (Figure 2). Take note of screw head direction (Figure 3). Screw heads should be accessible when system is installed on motorcycle for adjustment purposes. Use #20 hose clamps on head pipes. **NOTE:** Do not install muffler body heat shields at this time.
8. Using stock flange nuts, carefully install head pipes into exhaust ports (Assistance may be required). **NOTE:** Do not tighten at this time.

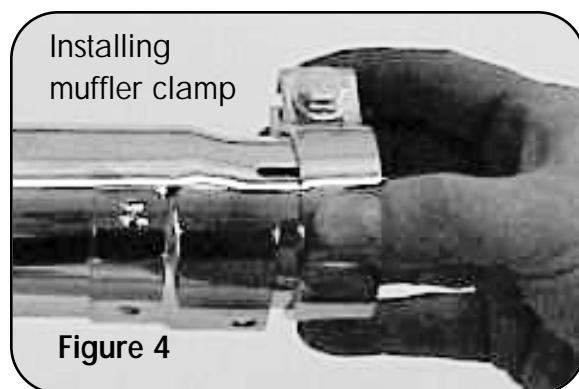
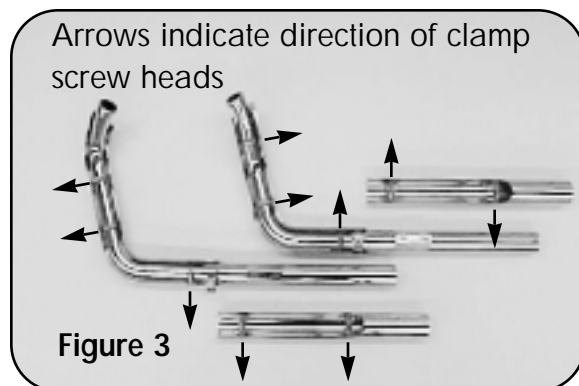
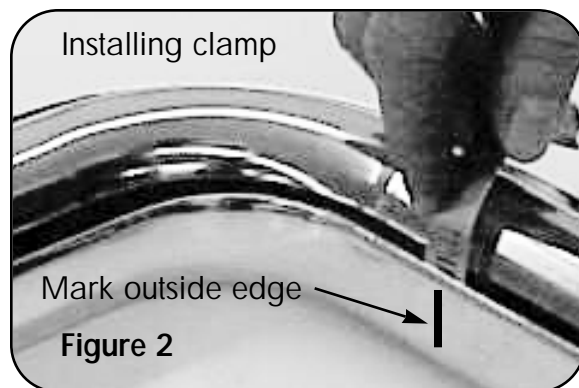
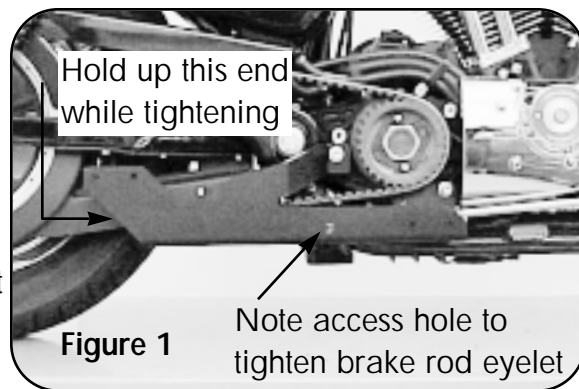

9. Loosely install 5/16" x 1-1/4" bolt and locknut with washers onto chromed muffler clamp (see Packing list). Install clamp onto muffler bodies (Figure 4). Beginning with the front pipe, slide muffler bodies onto head pipes. **NOTE:** Take care to slide heat shield alignment clips under head pipe heat shields.
10. Slide nut plates inside bracket that is welded to backside of muffler bodies (Figure 5). While holding nut plates in place, attach muffler bodies to mounting bracket 356-P using two 5/16" x 5/8" flange head bolts (supplied). Leave them loose at this time.
11. Repeat for rear head pipe.
12. Align muffler bodies so they are level and parallel when viewing from the right side of the bike. Tighten cylinder port exhaust flange nuts on front and rear cylinders.
13. Tighten the flange bolts on both mufflers.
14. Tighten clamps securing muffler bodies to head pipes.
15. Install hose clamps loosely into muffler body heat shields. Take note of clamp head direction (Figure 3). Screw heads should be accessible when system is installed on motorcycle for adjustment purposes. Use #28 hose clamps on muffler bodies.
16. Slide heat shields onto muffler bodies and align with heat shields on head pipes. **NOTE:** Top edge of muffler heat shield should align with top edge of head pipe heat shield and both heat shields should butt together (Figure 6).
17. Tighten all heat shield clamps.
18. Check for adequate clearance between all exhaust system components and motorcycle accessories prone to heat damage.
19. **Be sure to tighten all hardware before starting motorcycle.**

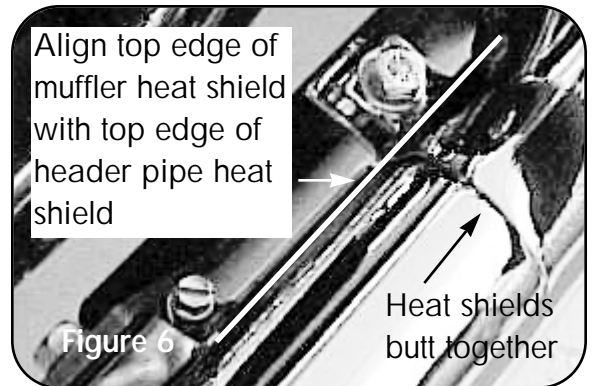

Option

Vance & Hines also offers Quiet baffles for this system, part number 21869. This will lower the sound level 2-3db on average. Order it today from your dealer or go to vanceandhines.com for more information.

RE-JETTING INSTRUCTIONS

Re-jetting the carburetors will result in realizing the "full" potential of this performance exhaust system.. Vance & Hines offers jet kits for most applications.

PLEASE NOTE:

Every effort is made for Vance & Hines Exhaust Systems to provide improved cornering clearance. However, due to design and space limitations on some motorcycle models, ground and cornering clearance may not be improved and in some cases may be reduced. Be sure to follow proper installation instructions.

PACKING LIST (All parts actual size)

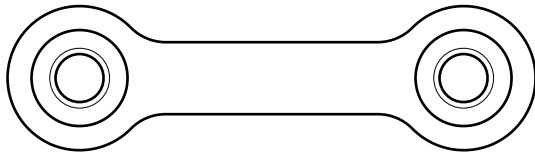

Nut plate x 2

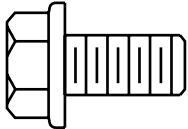

5/16" x 5/8" Flange Bolt x 4

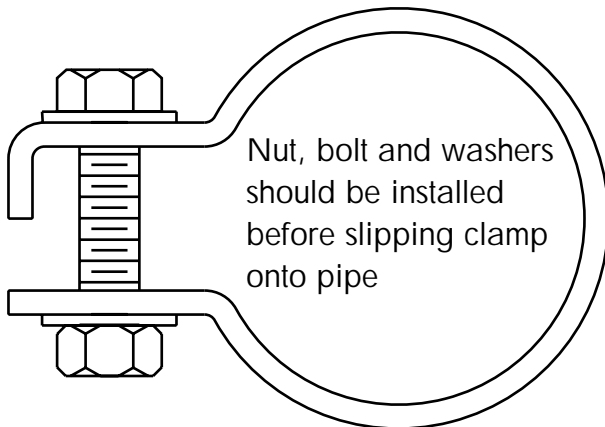

Chromed muffler clamp assembly x 2

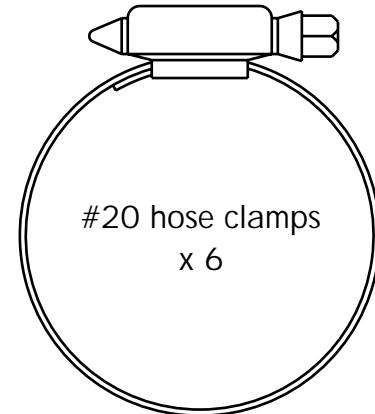

#20 hose clamps
x 6

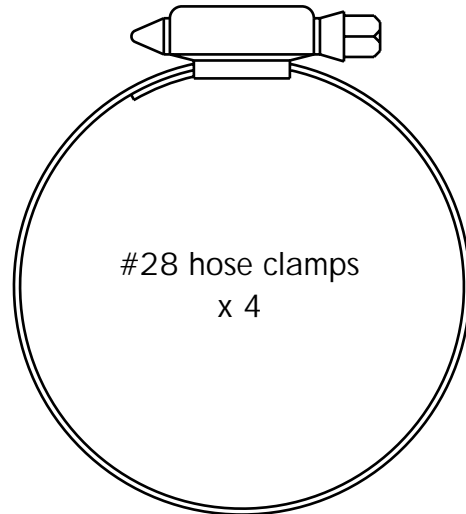

#28 hose clamps
x 4

HELPFUL HINTS TO AVOID DISCOLORATION OF EXHAUST PIPES

1. Follow owner's manual instructions regarding use of the choke (starter enricher). If left on longer than recommended, discoloration may be accelerated.
2. Avoid long periods of idling.
3. Intake leaks can cause engine to run lean and overheat, thus turning the pipes blue.
4. Make sure there are no exhaust leaks at the junction of the exhaust pipe and cylinder head.
5. When installing a new set of chrome pipes, make sure your hands are clean and free of oil. After installation, thoroughly clean pipes with a cleaning solvent that will leave no residue (glass cleaner, alcohol, ammonia, etc.) before starting the motorcycle.

WARNING!

VANCE & HINES DOES NOT WARRANTY ANY CHROME PRODUCTS AGAINST DISCOLORATION.

For information on other Vance & Hines products visit our web site at www.vanceandhines.com