

**CONGRATULATIONS!** You have purchased the finest exhaust system available for your motorcycle. Your VANCE & HINES exhaust system is designed for today's rider, a rider who needs maximum performance, great styling and a perfect fitting system. Please follow the installation instructions below and if you have any questions, feel free to call our technical help line (562) 926-5291. Attention Installer: (if other than owner): Please forward this instruction sheet to the purchaser of this product. These instructions contain valuable information necessary to the end user.



### STOCK EXHAUST SYSTEM REMOVAL

1. Remove both frame covers. Remove the left cover first to access a bolt that holds the right side cover in place.
2. Loosen right side floorboard assembly held in place by two bolts (Figure 1).
3. Remove exhaust port Allen nuts.
4. Remove Allen bolts securing rear muffler to exhaust system mounting bracket.
5. Remove complete exhaust system. Begin by lifting muffler out of mounting bracket locating hole (assistance may be required).
6. Check condition of stock exhaust gaskets. Replace if damaged or worn.

### Tools required for installation:

5mm, 6mm & 8mm Allen wrenches  
8mm, 10mm & 1/2" socket  
3/8" Ratchet & Extensions  
8, 10, 12 & 17mm Wrenches  
1/2" Wrench  
5/16" nutdriver/flat blade screwdriver  
Ft/lb. & In/lb. Torque wrenches  
Brake bleeder & fluid

7. Remove two bolts attaching stock exhaust mounting bracket to frame.
8. Remove hose clamp securing rear brake hose to exhaust mounting bracket.
9. Remove brake hose banjo bolt from rear caliper.
10. Slide hose out of loop in bracket.
11. Check condition of sealing washers on banjo bolt and replace if damaged or worn.
12. Reconnect brake hose to caliper (without bracket) and torque Banjo bolt to 25 lbs. ft.
13. Brake system must be bled or brake will not operate correctly. Refill reservoir after bleeding.

## VANCE & HINES EXHAUST SYSTEM INSTALLATION

1. Remove exhaust system and heat shields from protective packaging. Place exhaust on a non-abrasive surface such as a blanket or carpet. Using a non-permanent marker or tape, mark outside edge of each heat shield to show location of mounting clips that hose clamps will loop through (Figure 2).
2. Attach brake hose clamp to mounting bracket (stamped 362-P) using one 6x16mm flange bolt and nylock nut (supplied) to tab located on top of bracket (Figure 2).
3. Install mounting bracket using two 10x30mm Allen bolts and lock nuts (supplied)(Figure 3).
4. Carefully slide heat shields onto headers.
5. Loosely install each hose clamp by feeding tail end of clamp into heat shield clip (Figure 4). Use #20 hose clamps for head pipe areas and #36 hose clamps for muffler areas. Take note of clamp screw head direction (Figure 5). Screw head should be accessible when system is installed on motorcycle for adjustment purposes. Note: Do not tighten yet.
6. Using stock Allen nuts, carefully install system into exhaust ports starting with the rear port first. (Assistance may be required). **Note:** Do not tighten yet.
7. Slide dog bone shaped nut plate (supplied) inside each bracket welded to backside of mufflers (Figure 6).
8. Attach mufflers to mounting bracket (362-P) using 5/16" flange bolts (supplied) engaging dog bone nut plate. Note: Do not tighten yet.
9. Tighten exhaust port flange nuts securing head pipes to cylinder heads.

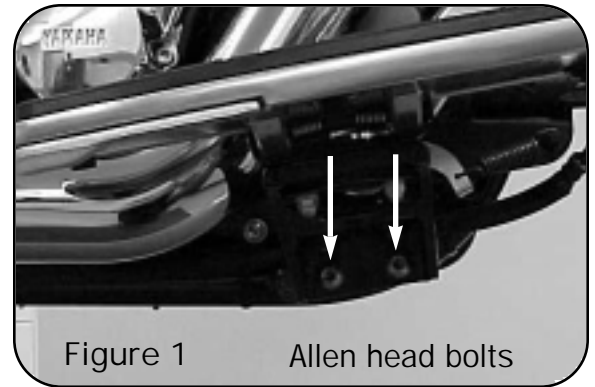

Figure 1 Allen head bolts

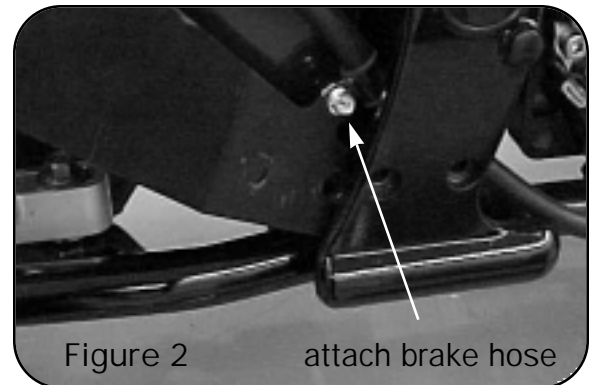

Figure 2 attach brake hose

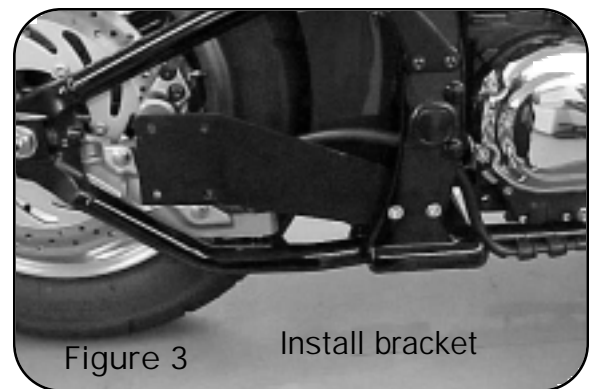

Figure 3 Install bracket

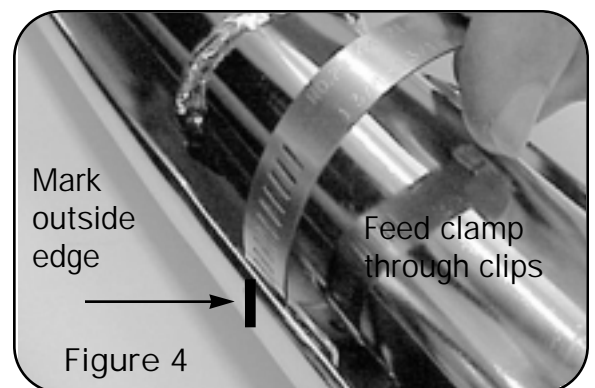

Figure 4

10. Tighten 5/16" flange bolts securing mufflers to mounting bracket.

11. Slide muffler heat shield (K342HC) on from the rear and loosely install four #36 hose clamps. Note position and direction of screw heads (Figure 5).

12. Be sure the rear of the muffler extends 1/4" beyond the end of the heat shield (Figure 7).

13. Tighten clamps on head pipe heat shields.

14. Tighten hose clamps on muffler heat shield. Check that heat shield is centered on the muffler bodies when viewed from the rear (Figure 8).

15. Tighten right side floorboard. Some models require spacers to provide adequate clearance to exhaust pipe. If necessary, install 1/2" x 1" spacers and 10 x 25mm button head allen bolts to space out floorboard.

16. Reinstall side covers, right side first.

17. Check for adequate clearance between all exhaust system components and motorcycle accessories prone to heat damage.

18. After installation and before starting motorcycle, completely clean pipes and mufflers with cleaning solvent and a clean, soft cloth that will not leave a residue. Note: Any residue, oil, or fingerprints will stain the chrome when the metal heats up.

**19. All hardware must be properly tightened before starting motorcycle.**

## RE-JETTING INSTRUCTIONS

Re-jetting the carburetors will result in realizing the "full" potential of this performance exhaust system. Vance & Hines offers jet kits for most applications. For fuel injected models, we recommend the use of an adjustable fuel management system.

PLEASE NOTE: Every effort is made for Vance & Hines Exhaust Systems to provide improved cornering clearance. However, due to design and space limitations on some motorcycle models, (center stand, oil filter, oil pan etc.) ground and cornering clearance may not be improved and in some cases may be reduced. Be sure to follow proper installation instructions.

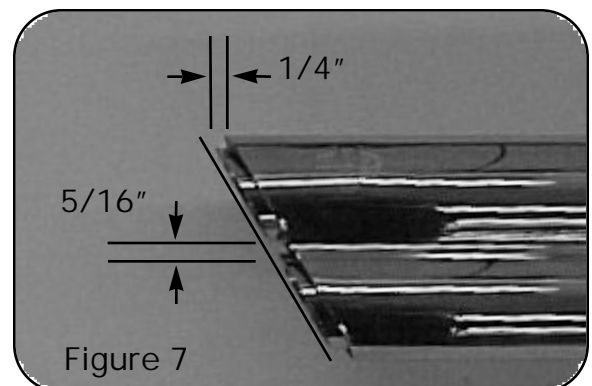
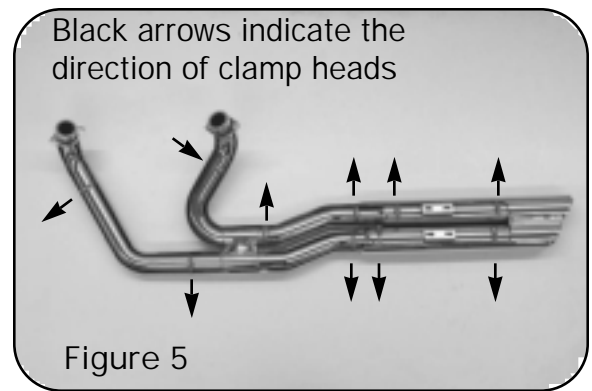

PACKING LIST (All parts actual size)

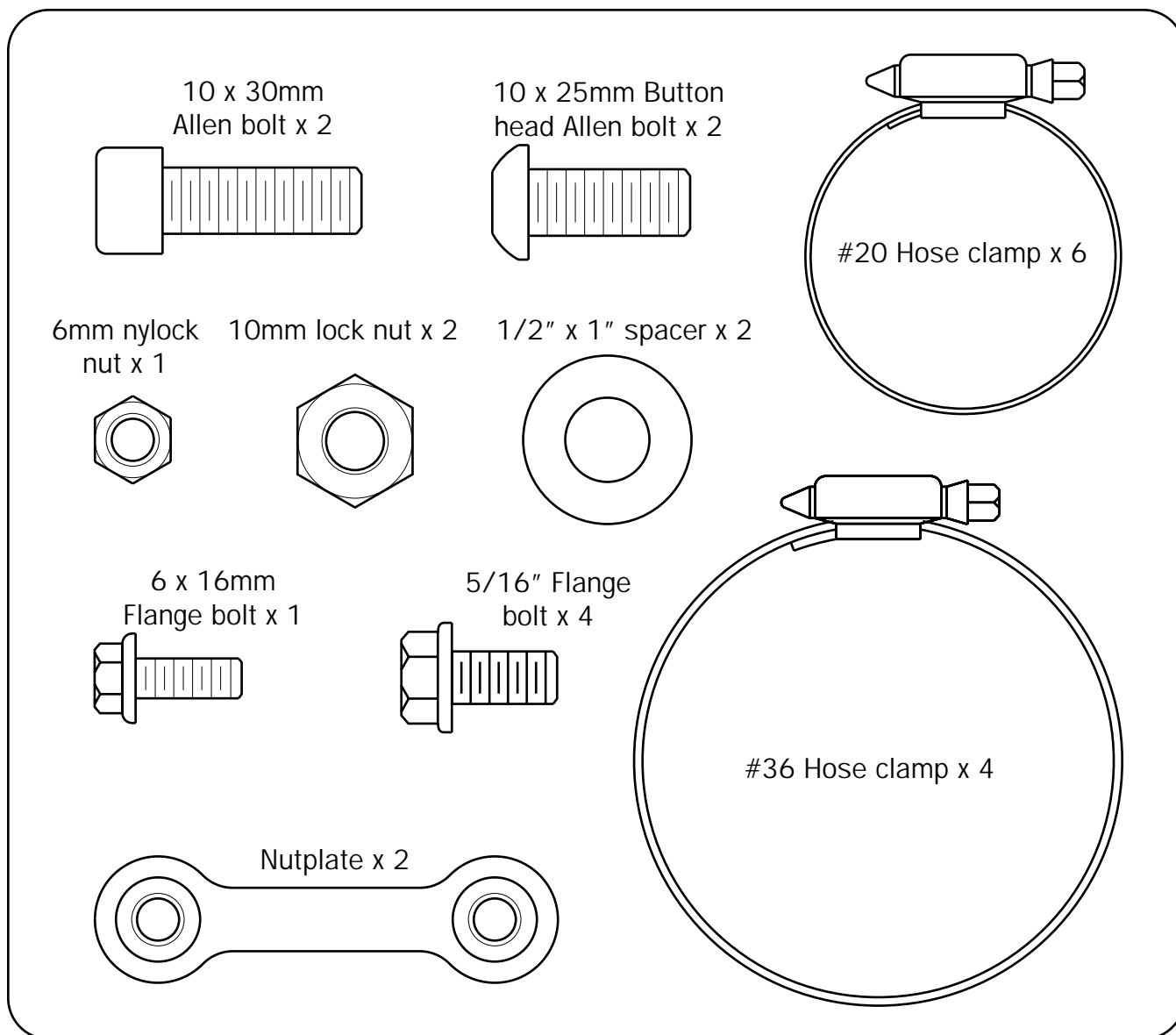

HELPFUL HINTS TO AVOID DISCOLORATION OF EXHAUST PIPES

1. Follow owner's manual instructions regarding use of the choke (starter enricher). If left on longer than recommended, discoloration may be accelerated.
2. Avoid long periods of idling.
3. Intake leaks can cause engine to run lean and overheat, thus turning the pipes blue.
4. Make sure there are no exhaust leaks at the junction of the exhaust pipe and cylinder head.
5. When installing a new set of chrome pipes, make sure your hands are clean and free of oil. After installation, thoroughly clean pipes with a cleaning solvent that will leave no residue (glass cleaner, alcohol, ammonia, etc.) before starting the motorcycle.

**WARNING!**

VANCE & HINES DOES NOT WARRANTY ANY CHROME PRODUCTS AGAINST DISCOLORATION.

For information about other Vance and Hines products visit our web site at [www.vanceandhines.com](http://www.vanceandhines.com)