

Congratulations, you have purchased the finest exhaust system available for your motorcycle. Your Vance & Hines exhaust is designed and crafted for performance, quality, and style. Please follow the instructions below, check exhaust system for missing or damaged parts and if you need any assistance please contact our technical support line (562) 921-7461.

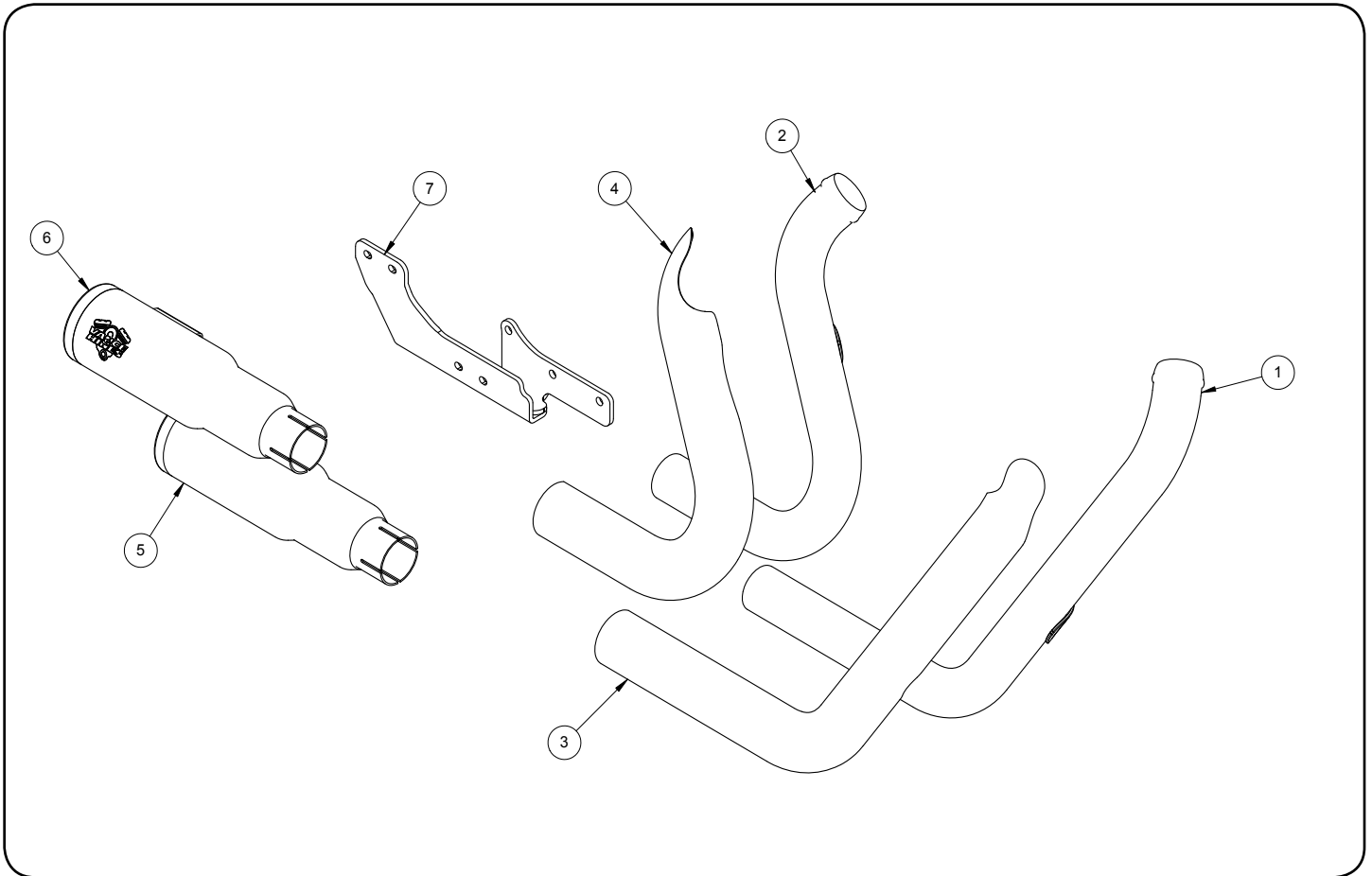

PARTS LIST

NO.	PART NO.	Description	Qty.
1	D870FC	Front Head Pipe	1
2	D871FC	Rear Head Pipe	1
3	D870HC/D878HP	Front Heat Shield	1
4	D871HC/D879HP	Rear Heat Shield	1
5	D588RC/D688RP	Front Muffler Assembly	1
6	D589RC/D689RP	Rear Muffler Assembly	1
7	1137-P	Mounting Bracket	1
8	A328HW	Barrel Band Clamp	2
9	A270HW	Hose Clamp	6
10	A644ST	18-12mm O2 Adaptor	2
11	A139HW	1/4-20 x 1/2 Flange Bolts	4
12	A107HW	5/16" Flat Washer	3
13	A345HW	5/16-18 x 1-1/2" Hex Head Bolt	3

HARDWARE

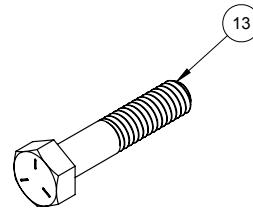
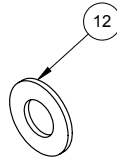
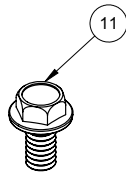
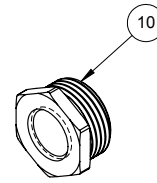
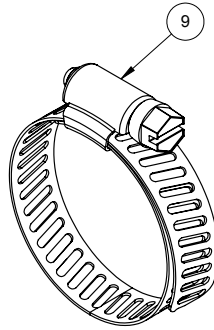
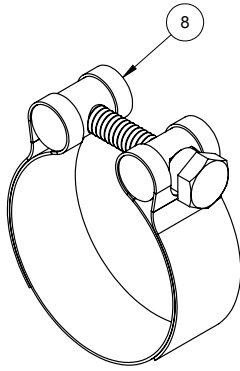

TOOLS REQUIRED

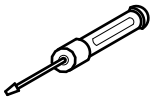

**Screwdrivers: Flat head,
#3 Phillips head**

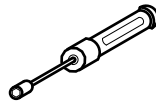

5/16" Nut Driver

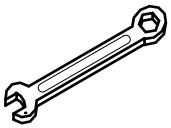

**Combination Wrench:
1/2", 9/16", 7/8" or
22mm, 14mm, 19mm**

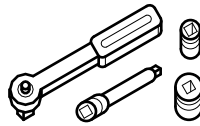

**3/8" Drive Ratchet
1/2", 9/16" Deep Socket,
10mm, 19mm Socket**

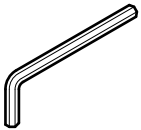

**Allen Wrenches: 3/16", 1/4"
Torx: T40**

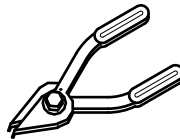

Snap Ring Pliers

STOCK EXHAUST SYSTEM REMOVAL

1. Remove seat to gain access to rear oxygen sensor connector. Unplug sensor and feed end of wire through frame to free it from motorcycle. **NOTE:** Pay attention to wire routing for re-installation.
2. For **2006-2011 models** remove two bolts holding rectifier onto front of frame (near front tire). Open plastic cover to gain access to front oxygen sensor connector. Unplug sensor from harness and feed end of wire through to free it from motorcycle. For **2012 and later models** the connector is located under the rectifier at the front of the motorcycle.
3. Loosen the heat shield clamps on both the front and the rear head pipes.
4. If equipped, remove the front heat pipe clamp carriage bolt.
5. Remove the bolt that attaches the header to the frame mounting bar.
6. Remove the two cylinder exhaust port flange nuts from each head pipe, located at the cylinder head.
7. Remove the complete exhaust system and set aside (Assistance may be required).
8. Position the muffler support bracket over the mounting location to determine which bolts to remove. Install removed bolts in the top hole left vacant by the new bracket. **(Figure 1)**
9. Carefully remove the flanges and circlips from the stock exhaust system using snapping pliers. **NOTE:** Replace bent or damaged circlips.
10. Remove stock oxygen sensors.
11. Check condition of exhaust gaskets and replace if worn or damaged. Harley-Davidson part number: 65324-83B.

VANCE & HINES EXHAUST INSTALLATION

1. Attach the muffler support bracket to transmission and tighten to 12-15 Ft./Lbs. using three 5/16 x 1-1/2" hex head bolts and washers (supplied).
2. Remove head pipes and heat shields from their protective packaging. Place each heat shield on a non-abrasive surface such as a blanket or carpet. Using a felt tip pen for chrome and pencil for black, lightly mark the outside edge of each heat shield to show the location of the mounting clips that hose clamps will loop through. **(Figure 2)**
3. Lay head pipes into their respective heat shields.
4. Install #20 hose clamps by feeding tail end of clamps into heat shield clips. Take note of clamp screw head direction **(Figure 2)**. Screw head must be accessible when system is installed on motorcycle for adjustment purposes.
5. Apply a small amount of anti-seize compound to the threads of the O2 sensors and install them into the new head pipe. **NOTE: 2006 - 2011** models or models using 18mm wideband oxygen sensors install sensor directly into head pipe. **2012 and later** models install supplied 18mm to 12mm oxygen sensor adapter then install 12mm oxygen sensors. (Grey connector into front head pipe, Black connector into rear head pipe.)
6. Install the exhaust port flanges and circlips from the stock system onto the new head pipes.
7. Using stock flange nuts, carefully install the head pipes into exhaust ports. Do not tighten the nuts at this time.

VANCE & HINES EXHAUST INSTALLATION CONTINUED

8. Slide muffler barrel clamp (supplied) onto inlet side of muffler assembly with bolt head to the inside and facing down (front muffler) and inside pointing up (rear muffler with logo). **(Figure 2)** Install front muffler assembly onto header assembly. Use the 1/4-20 x 1/2" flange bolts (supplied) to attach the muffler to the bracket. Do not tighten at this time. Repeat for rear muffler.
9. Tighten the exhaust system nut, bolts and clamps in the following sequence: (1) Head flange nuts (x4), (2) Muffler body 1/4" flange head bolts, (3) Barrel band clamp, (4) Front and rear heat shield hose clamps. Make sure the head pipes and mufflers are aligned parallel.
10. Feed the wire for the front oxygen sensor through the frame and into the plastic holder on the frame. Plug the sensor into the stock harness.
11. 2006-2011 models put the toothed edge of the wiring holder into the slot in frame. Re-install rectifier so that it fits under tooth of wiring holder, keeping it in place in the frame. Tighten both the bolts.
12. Feed connector for rear oxygen sensor through frame and into under seat compartment. Plug sensor into stock harness.
13. Reinstall the seat.
14. Be sure to tighten all hardware before starting the motorcycle.

EXHAUST CARE (CHROME)

1. When installing a new set of chrome pipes, make sure your hands are clean and free of oil. After installation, thoroughly clean pipes with a soft cloth and cleaning solvent that will leave no residue (chrome wax / polish, glass cleaner, alcohol, ammonia, etc...) before starting the motorcycle.
2. Avoid long periods of idling as this can cause discoloration.
3. Intake leaks can cause the engine to run lean and overheat, this could lead to discoloration.
4. Make sure there are no exhaust leaks at the junction of the exhaust pipes and cylinder head. We recommend replacing gaskets if they are worn.

EXHAUST CARE (BLACK)

1. When installing a new set of black pipes, make sure your hands are clean and free of oil. After installation, thoroughly clean pipes with warm soapy water and a soft cloth. Dry with a clean towel to remove any residue before starting the motorcycle. Do NOT use anything abrasive to clean pipes.
2. Avoid long periods of idling as this can cause discoloration.
3. Intake leaks can cause the engine to run lean and overheat, this could lead to discoloration.
4. Make sure there are no exhaust leaks at the junction of the exhaust pipes and cylinder head. We recommend replacing gaskets if they are worn.

FIGURE 1

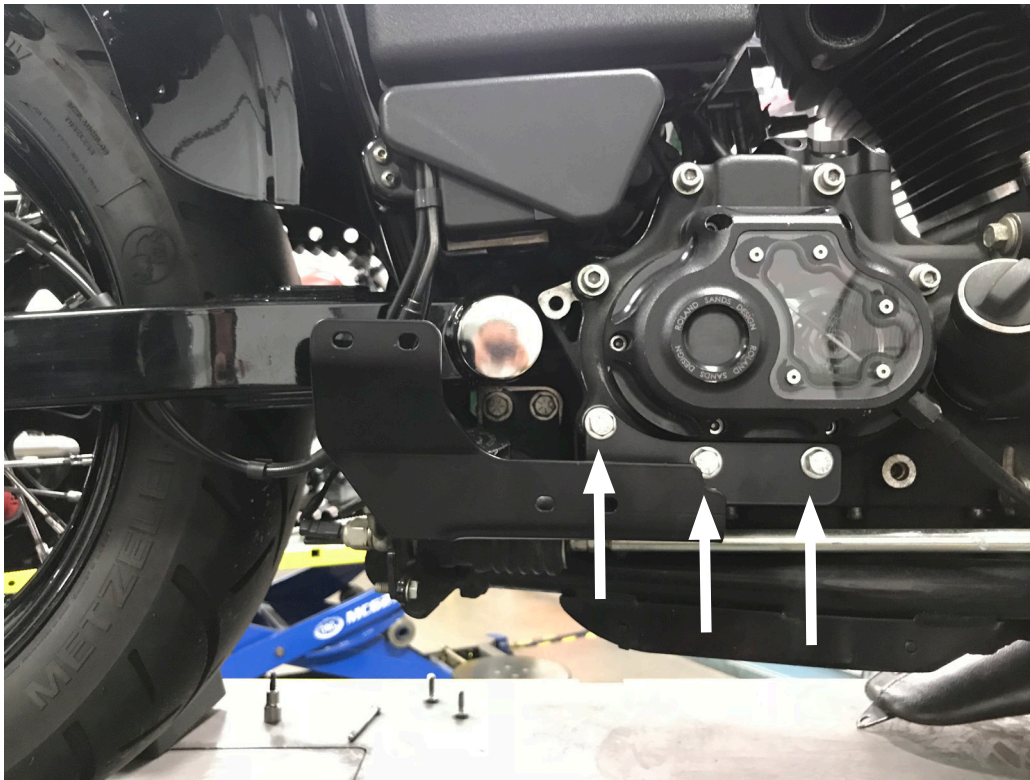
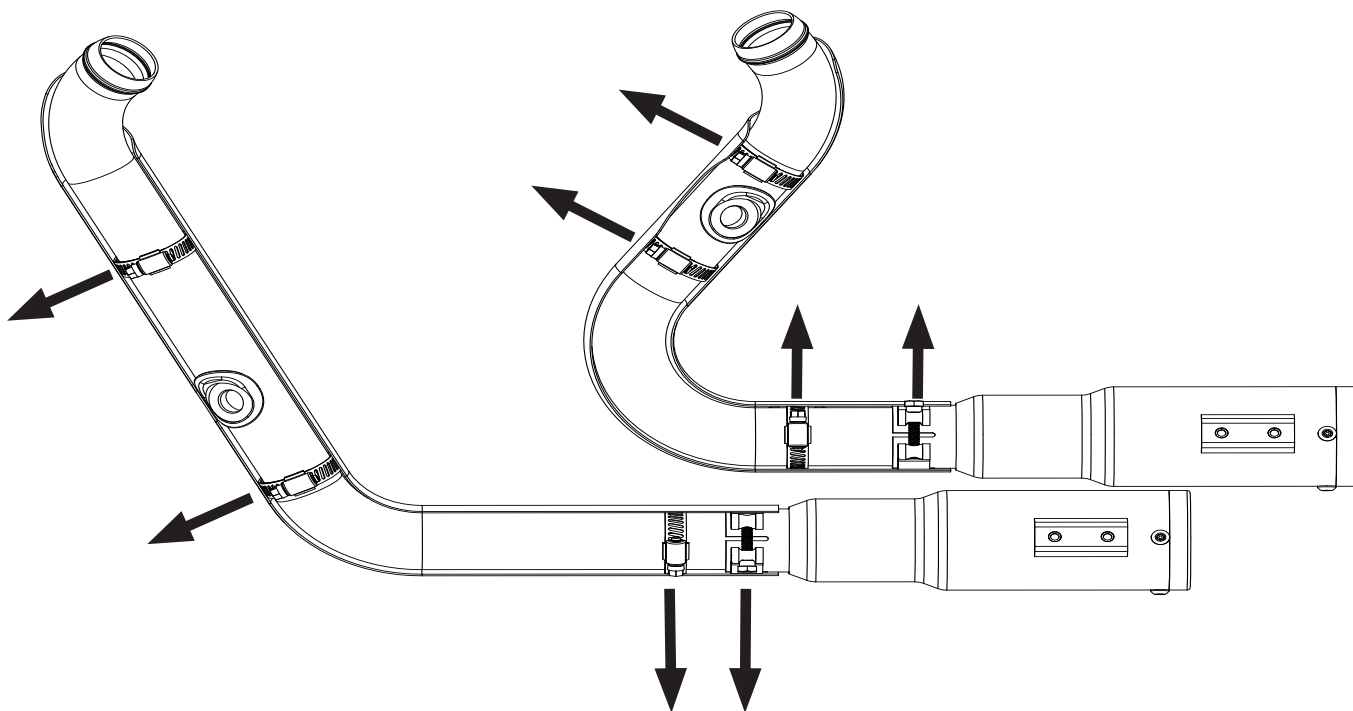

FIGURE 2



Emissions Notice:

In California, in order to meet Air Resources Board emissions requirements, certain aftermarket part applications have been identified as replacements, and others have received ARB Executive Orders. All other emissions related aftermarket parts are for competition use only. A list of replacement parts and EO parts, and corresponding fitment is provided at vanceandhines.com/California.

Warranty:

All Vance & Hines products are warranted against defects in material and workmanship for a period of 90 days. This warranty does not cover discoloration or rust. This warranty shall be limited to the repair or replacement of the product, which may be proven defective under normal use. Vance & Hines will not warranty any system that has been abused, misused, improperly installed or modified.

Dealers or distributors are not authorized to make dispositions binding upon Vance & Hines. Vance & Hines will not be responsible for any labor charges incurred in removing or replacing any system under warranty. A return authorization number and a copy of the original purchase invoice must accompany all returns. Parts returned without a return authorization may be refused.

13861 ROSECRANS AVENUE / SANTA FE SPRINGS, CA 90670
SALES: (562) 921-5388
TECHNICAL: (562) 926-5291
FAX: (562) 802-0110

vanceandhines
.com